

# IMPORTANT READ THIS

## RS115 STUMP POLE

This sheet to be read in conjunction with NAL sheet ref's **B1;B2** and **Civils Installation**.

### Pedestrian Plug

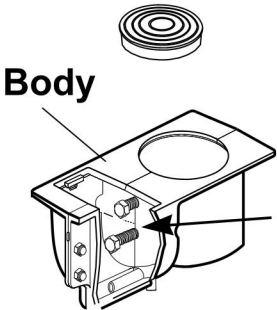

**Remove** the Pedestrian plug,

**ENSURE** the two stainless steel bolts do not obstruct the Stump Pole from entering the socket.

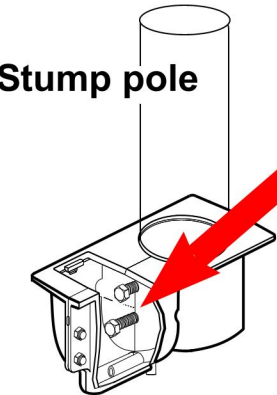

Place Stump Pole into the socket.

**Tighten the two** 16mm stainless steel bolts against the Stump Pole making sure that the stump pole is in a **VERTICAL** position.

**Use the stump pole to achieve a vertical level.**

**NEVER** Level the socket from the head of the socket or by using a piece of ducting.

Once vertical level is achieved, compact concrete.

# IMPORTANT READ THIS

## RS115 STUMP POLE

This sheet to be read in conjunction with NAL sheet ref's **B1;B2** and **Civils Installation**.

### Pedestrian Plug

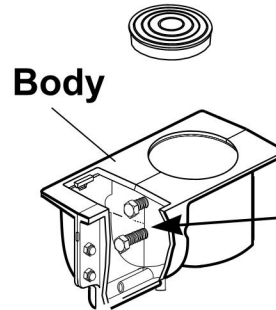

**Remove** the Pedestrian plug,

**ENSURE** the two stainless steel bolts do not obstruct the Stump Pole from entering the socket.

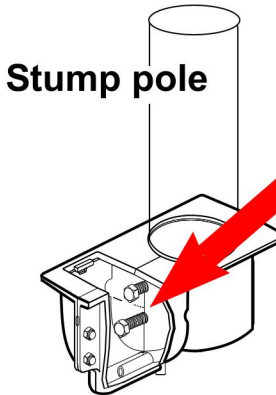

Place Stump Pole into the socket.

**Tighten the two** 16mm stainless steel bolts against the Stump Pole making sure that the stump pole is in a **VERTICAL** position.

**Use the stump pole to achieve a vertical level.**

**NEVER** Level the socket from the head of the socket or by using a piece of ducting.

Once vertical level is achieved, compact concrete.

